

## Hydraulic Excavator Pump Attachment - 8 Inch

### MODEL #

8-Inch EXF 8000 Hydraulic Excavator Attachment

### OPERATING LEVELS

MIN FLOW	1400 GPM
MAX FLOW	3600 GPM
HEAD RANGE	Up to 230 ft
DISCHARGE SIZE	8 inch
SUCTION SIZE	10 inch
SOLIDS HANDLING	Solids up to 7 inches
MAX SPEED	1200 RPM
PERCENT SOLIDS	Up to 40-70% Solids
PRODUCTION RATE	250-300 yd <sup>3</sup> material/hr



\*Typical Attachment Photo. Photos for general guidance. Contact us for further details.

### RECOMMENDED SENSORS

Hydraulic Pressure Gauge for pumps and cutter head circuit to operator (0-6000 PSI)

Magnetic Flow meter to maintain stable plug free pipeline flow and maximize production

### REQUIRED EQUIPMENT TO OPERATE ATTACHMENT

EDDY Pump circuit requirements from excavator auxiliary power OR from Hydraulic Power Unit 120 GPM at 5000 PSI (500cc motor)

Cutterhead circuit requirements from excavator auxiliary power OR from Hydraulic Power Unit 20-28 GPM at 5000 PSI (2150cc motor)

8" material handling discharge hose and hydraulic lines plumbed out to the end of the boom

Crossover check valve to prevent damage to hydraulic motor and prevent pump rotor from coming off

Minimum excavator carrier weight requirements: 60-94 tons / 54,400-85,000 kg

MAXIMUM LINKAGE  
DIMENSION

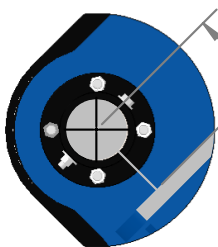

[140mm]  
5.5in

LINK PIN

STICK PIN

### STANDARD PIN SIZING

PART #	SIZE
01425	Ø 80 MM
12877	Ø 90 MM
06661	Ø 100 MM
01042	Ø 110 MM

\*CUSTOM SIZES AVAILABLE UPON REQUEST

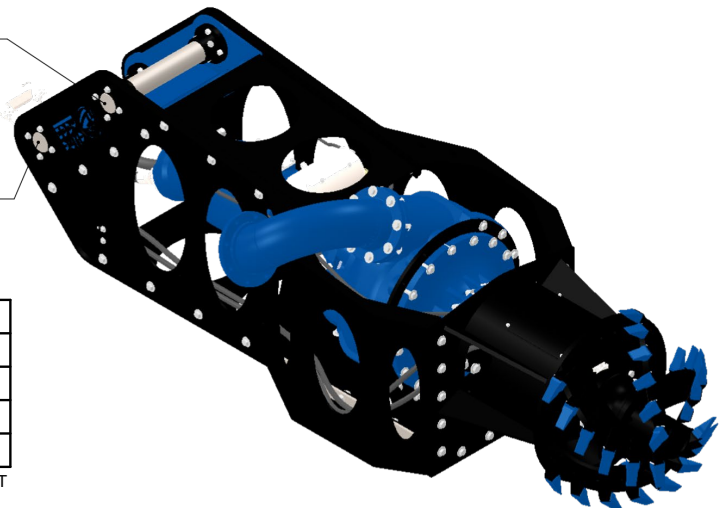

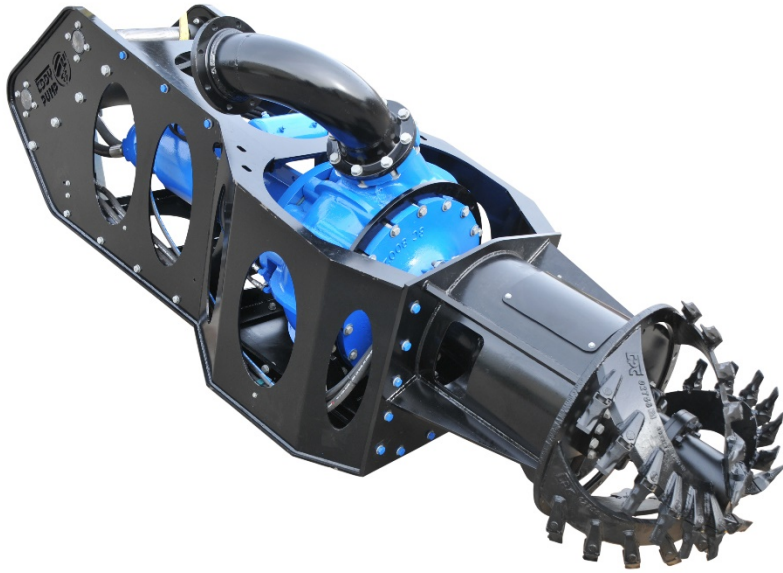

**EDDY Pump industrial Excavator Dredge Pump Attachments** are non-clog pumps designed for high solids industrial pumping applications. Our patented pump technology outperforms all centrifugal, vortex and positive displacement pumps in a variety of the most difficult pumping applications.

Available in alternative power options and pump sizes depending on your application.

### Applications

- Mining
- Chemical
- Sand & Agg
- Oil and Gas
- Paper & Pulp
- Fly Ash & Coal Ash

### Features and Benefits

- Non-Clog, High Viscosity, High Specific Gravity, High Abrasives, Low pH Pumping Design
- Transport 40-70% Solids
- Ability to pump objects of up to 9-inches in diameter

### Fluid Pumped

- Sludge
- Slurry
- Drilling Mud
- Mine Tailings
- Grit
- Sand Mixtures

## GENERAL SPECS

Overall Weight (without optional equipment)	6,800 lbs	3,084 kg
---	-----------	----------

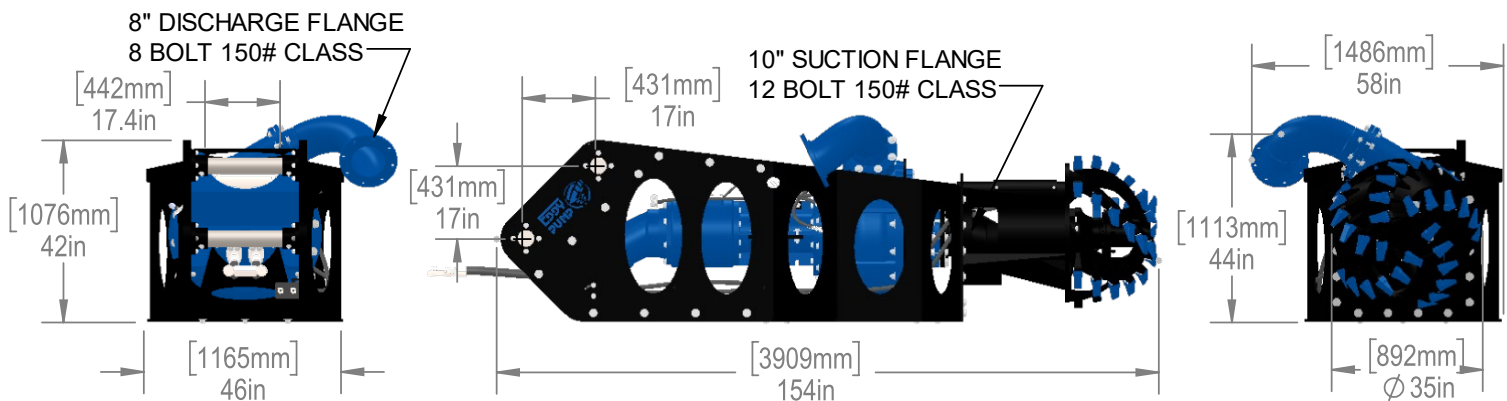



## OPTIONAL EQUIPMENT TO ENHANCE OPERATION OF DREDGE

Magnetic flow meter
Discharge line pressure gauge (0-150 psi)
"Quick Prime" Valve (requires small 24volt air system)
Pivot mounted Discharge hose carrier (adaptable to most machines)
Recirculation system for pre-mixing applications (requires small 24 volt air system)



STANDARD CUTTER HEAD



SELF-CLEANING HEAD



WATER JETTING RING



LINER-SAFE WHEELS



RE-CIRCULATION



EXTENDED CUTTER HEAD

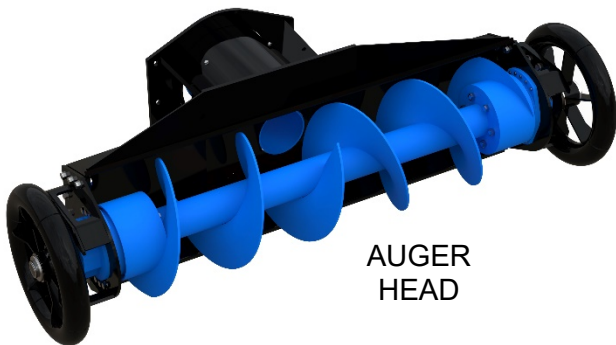

AUGER HEAD



MIXER HEADS

## PUMP CURVE

A pump curve is a graphical representation of a pumps ability to produce flow against a certain head. The science is matching a curve that is accurate for your project, leading to the proper pump selection and best efficiency. **EDDY Pumps** are primarily used for high solids, slurry, sludge, and dewatering.

### EDDY Pump - 8 Inch HD 8000 Heavy Duty Slurry Pump - Pump Curve

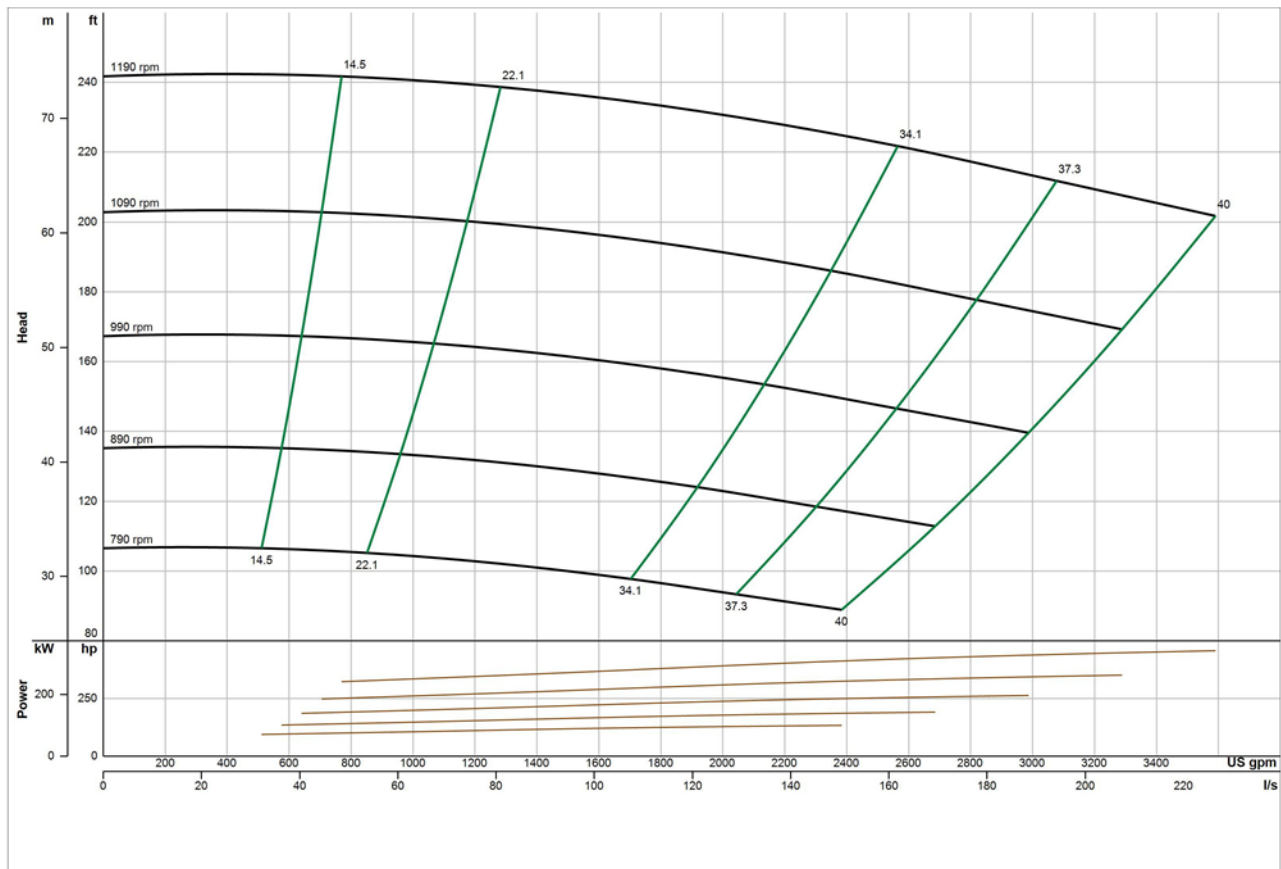

\*General pump curve based on water with 1200 RPM motor. Contact us with your specific material for a custom pump curve.

## WE PUMP SOLIDS, NOT WATER

CONTACT US



(619) 258-7020



info@EddyPump.com